



CLIMB ON

DESCENT CONTROL HANDLE REPLACEMENT

READ THESE INSTRUCTIONS COMPLETELY BEFORE YOU START. IF YOU DON'T UNDERSTAND THESE INSTRUCTIONS, PLEASE CALL 800-453-1192 FOR ASSISTANCE

Procedure for replacing the Descent Control handle on Little Giant Ladder Systems **Adjustable Safety CAGE and Compact Safety CAGE**.

1. Failure to comply with all instructions may result in serious injury.
2. Make sure this kit is compatible with your CAGE. Before installing this kit, identify all kit components. If any components are missing, damaged or if you have any questions concerning the use of this kit on Little Giant Ladder Systems products, please contact our Customer Experience Team at 800-453-1192. Do not substitute any components.
3. Inspect the CAGE before installing this kit. Repair or replace any damaged or missing CAGE parts before using the ladder. Use only Little Giant Ladder Systems repair or replacement parts. If you are unable to repair it, discard the CAGE.

COMPONENTS IN KIT

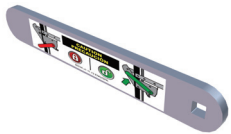

(1) HANDLE

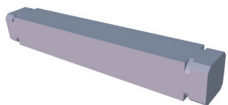

(1) SQUARE KEY



(2) SQUARE KEY BUSHINGS



(2) AXLE CAPS

TOOLS NEEDED

SNAP RING PLIERS



NOTE: IF ANY OTHER PART OF THE CAGE IS DAMAGED BEFORE OR DURING THE PROCESS OF INSTALLING AND/OR REPAIRING, PLEASE CONTACT OUR CUSTOMER EXPERIENCE TEAM FOR ASSISTANCE AT 800-453-1192. **DO NOT USE A DAMAGED CAGE!**

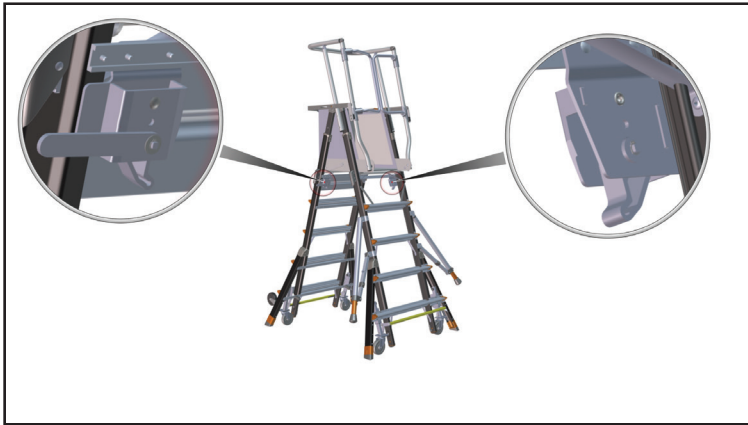

1. Locate the Descent Control handles on the CAGE.

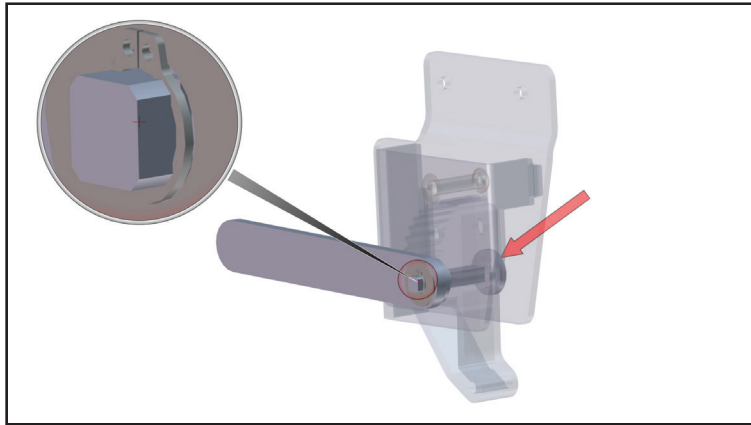

2. There are (2) snap rings located on the front and back of the Decent Control handle that are holding the square key in place.

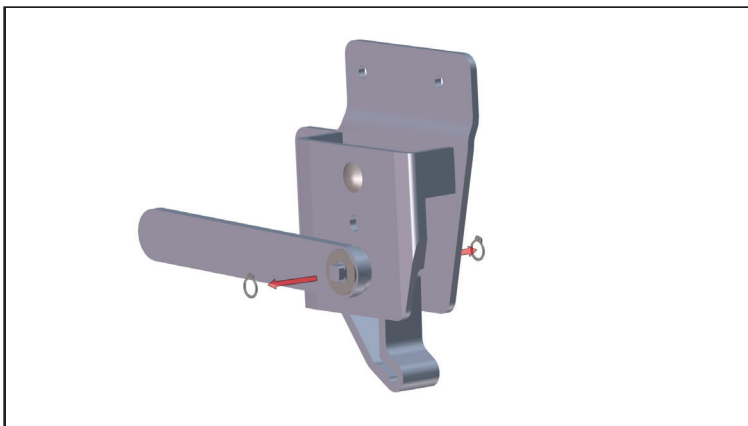

3. Using a pair of snap ring pliers, remove the (2) snap rings, then discard them.

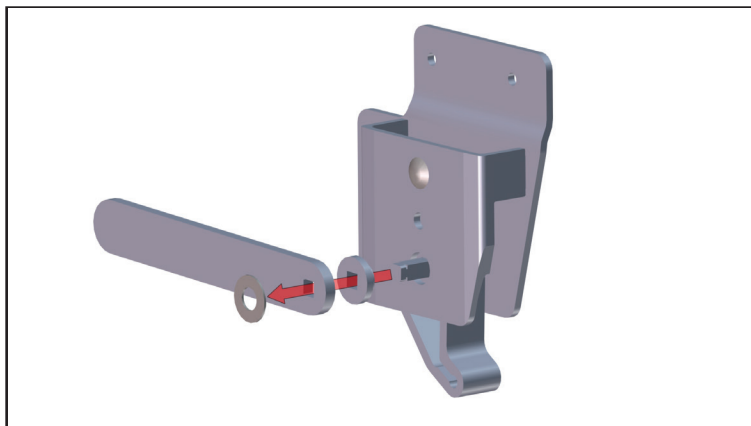

4. Once the (2) snap rings have been removed, remove the washer, handle, and square key bushing (as shown in the illustration), then discard.

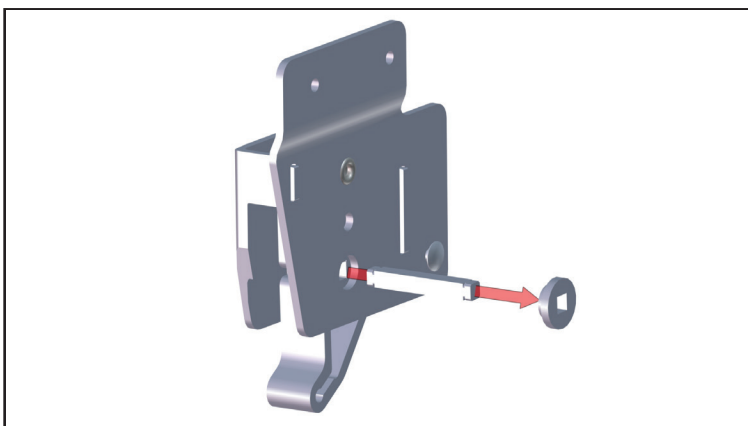

5. On the rear of the Descent Control housing, remove the square key bushings and square key (as shown in the illustration), then discard.

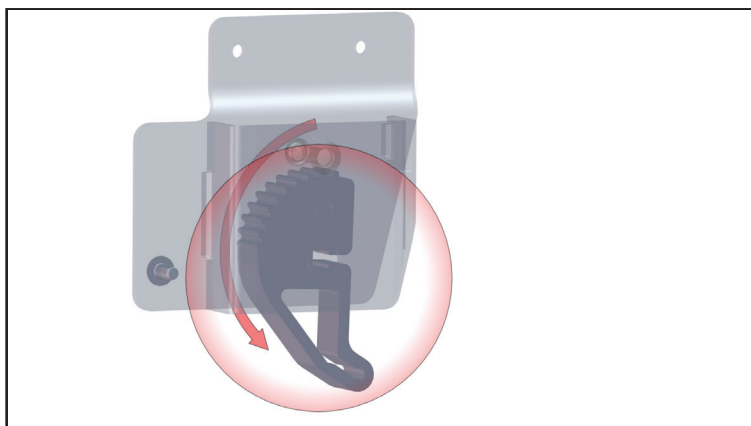

6. Make sure that you keep the rope brake cam locked in the position shown (the rope MUST follow the path of the arrow).

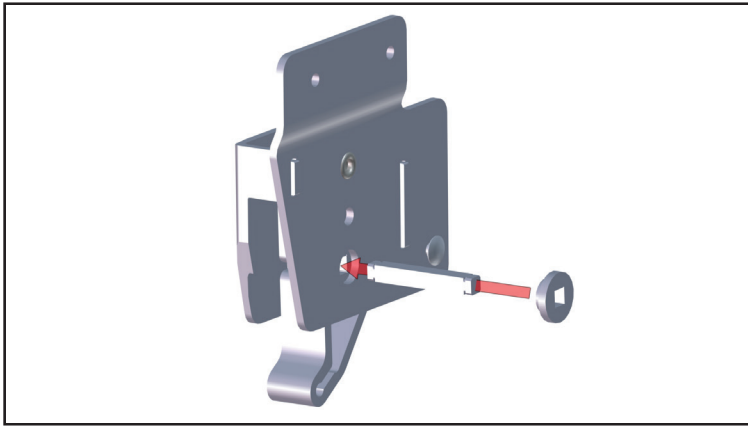

7. Insert the (new) square key and (new) square key bushing through the Descent Control housing and rope brake cam from the rear of the Descent Control housing.

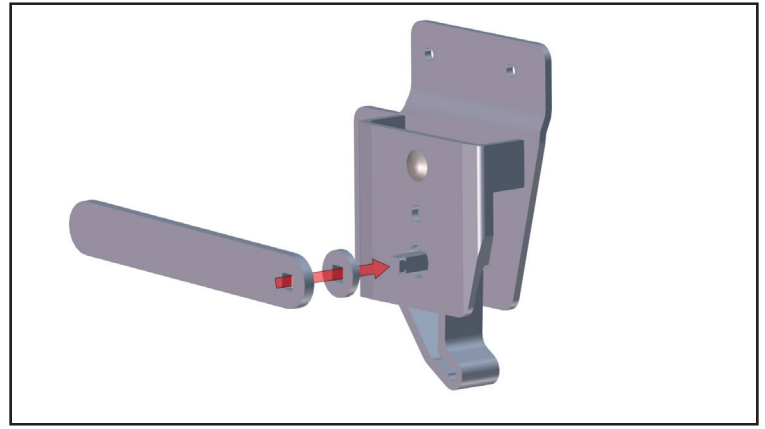

8. On the front of the Descent Control housing, insert the (new) square key bushing and the (new) handle (as shown in the illustration).

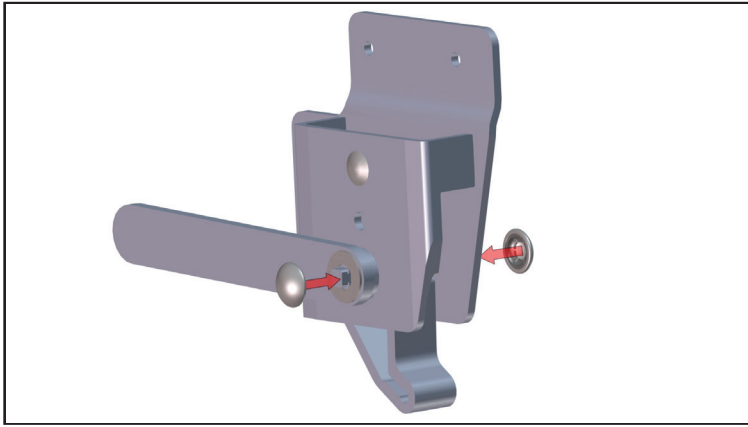

9. Line up and place the (2 new) axle caps on either end of the square key.

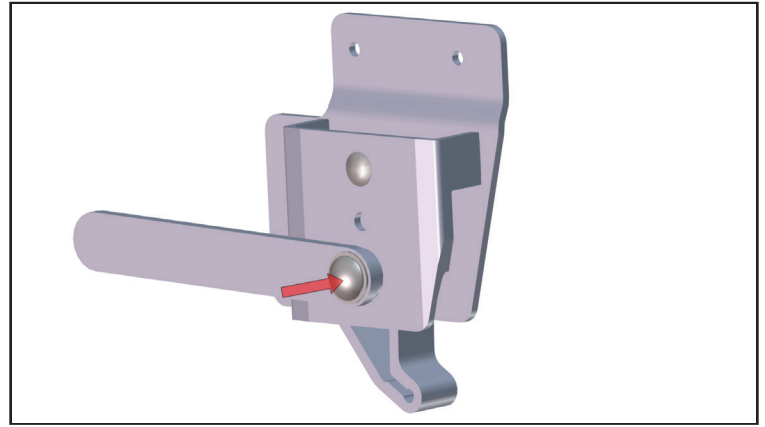

10. Push the (2 new) axle caps onto the ends of the square key with your thumb. **DO NOT USE A HAMMER FOR THIS STEP.** If you use a hammer you risk damaging the axle caps, and you will have to replace them. Once axle caps are on, make sure the Descent Control assembly functions properly before returning the CAGE to service.